

**NOTES:-**

- 1: CHECK THE STRUCTURAL DRG. WITH ARCH. DRG / ELEVATION / SECTION / 3D.
- 2: IF ANY AMBIGUITY FOUND, CONTACT STRUCTURE ENGG. IMMEDIATELY BEFORE STARTING WORK.
- 3: FOLLOW ONLY ARCHITECTURAL DIMENSIONS. IF ANY ACCIDENT OCCURS ON SITE DUE TO CONSTRUCTION FAULTS.
- 5: GET IT APPROVED BY ARCHITECT BEFORE STARTING EXECUTION OF WORK.
- 16: THIS STRUCTURE DRAWING IS BASED ON ARCH.DRG SENT BY MAIL ON DATE: 10-05-22



CONCRETE GRADE	
ITEM	GRADE
SLAB	M35
BEAM	M35
USE STEEL GRADE Fe 500D	

**For ZARNA ASSOCIATES**  
Structural Consultants  
Dr. V. R. PATEL  
Ph.D. (Str. Engg.) M.E. (Str.) B.E. (Civil)

PROJECT NAME:-	SBI CORPORATE OFFICE
ARCHITECT:	MAMTA SHAH
STRUCTURAL CONSULTANT:	ZARNA ASSOCIATES STRUCTURAL CONSULTING ENGINEER 9/10-915, Samanvay Silver Apartment, Mijmahada Crossing, Besides Royal Orchid Hotel, Akota Road, Vadodra-390020. Tele. ph. / mo. no. :- +91 92276-27339/40 +9183474-13334 to 39. E- Mail :- zarnassos@yahoo.com
APPROVED BY:	VRP
CHECKED BY:	RISHVA
DRAWN BY:	VIJAY
CORRECTED BY:	KIRAN
DATE:	21-12-2023
PROJECT NO.:	401/17
DRAWING TITLE:	STAIRCASE
DRG NO : 25	
SCALE: N.T.S.	SHEET: A3
	N

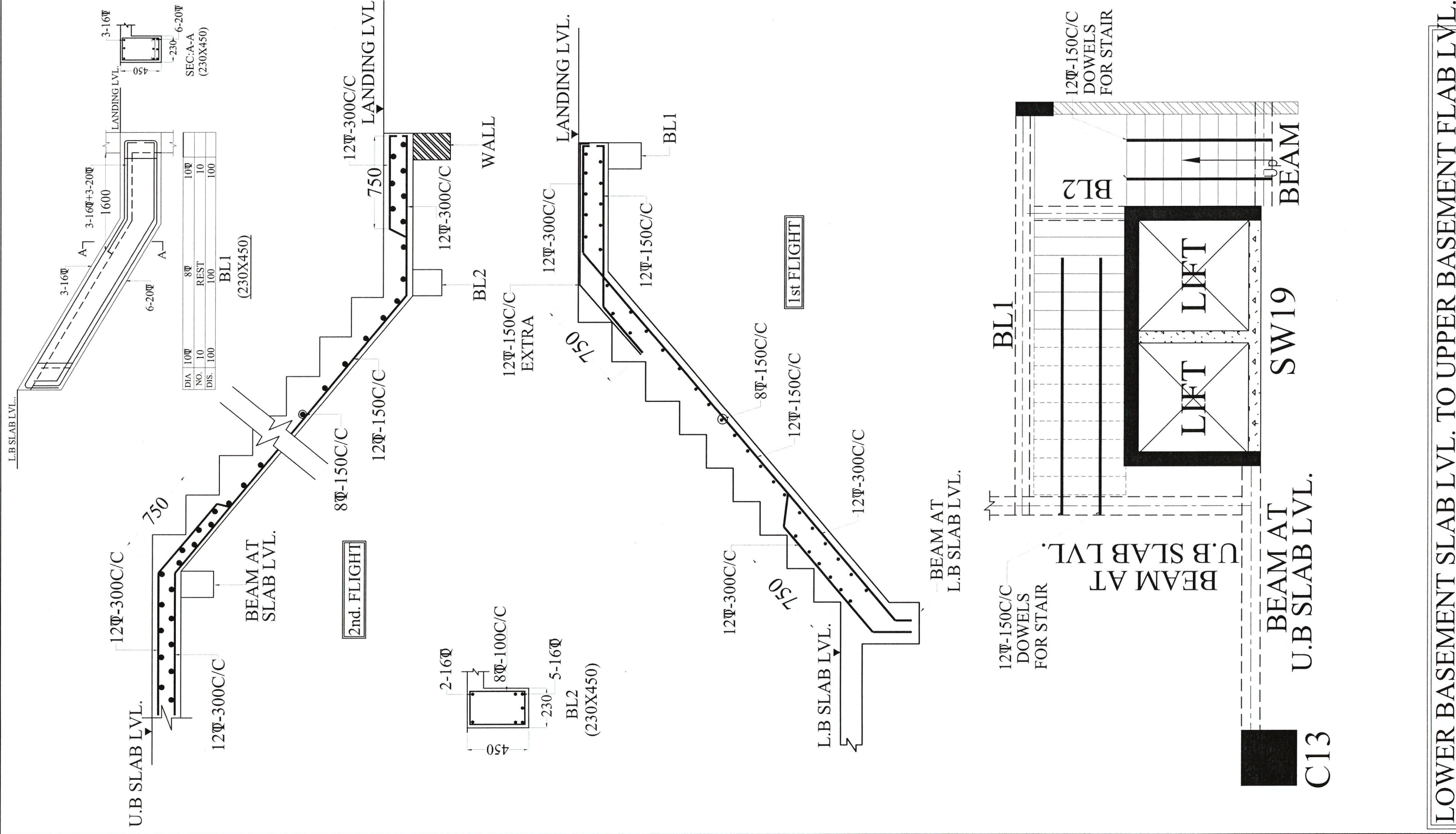

**LOWER BASEMENT SLAB LVL. TO UPPER BASEMENT FLAB LVL.**

**STAIRCASE**

**200 THK. WAIST SLAB**