

- NOTES:-
- PLEASE CHECK CENTER LINE AS PER ARCH. DRG. BEFORE STARTING WORK.
  - IF ANY AMBIGUITY FOUND, CONTACT STRUCTURE ENGG. IMMEDIATELY BEFORE STARTING WORK.
  - FOLLOW ONLY ARCHITECTURAL DIMENSIONS.
  - STRUCTURE ENGINEER IS NOT RESPONSIBLE IF ANY ACCIDENT OCCURS ON SITE DUE TO CONSTRUCTION FAULTS.
  - BOTTOM OF FOOTING SHOULD NOT BE ON FILLED UP SOIL. IF FILLED UP SOIL IS FOUND PLEASE INFORM STRUCTURE ENGINEER BEFORE START EXECUTION.
  - DO NOT EXCAVATE RAMP UNTILL BASEMENT SLAB IS CASTED.
  - PROVIDE DEPTH OF THE FOOTING FOR LIFT AS PER LIFT MANUFACTURER.
  - DO NOT PROVIDE PEDESTAL IN LIFT COLUMN ONLY.
  - PROVIDE FOOTING ADJOINING TO LIFT AT THE SAME LEVEL OF LIFT FOUNDATION.
  - DO NOT BACKFILL THE SOIL ON BACK SIDE OF RETAINING WALL UNTILL BASEMENT SLAB IS CASTED.
  - PROVIDE PLASTER ON BOTH SIDE OF WALL WITH WATER PROOFING ADMIXTURE.
  - TAKE ALL PRECAUTION DURING CONSTRUCTION OF BASEMENT SO THAT SIDE BUILDING FOUNDATION SHOULD NOT GET DAMAGED/OPENED.
  - DO NOT EXCAVATE RAMP WITHOUT CONSULTING STRUCTURE ENGINEER.
  - EXCAVATION OF RAMP SHOULD BE DONE AS PER SLOPE OF RAMP. DO NOT EXCAVATE ENTIRE RAMP UPTO FULL DEPTH.
  - EXCAVATION MUST BE DONE IN NATURAL SLOPE. i.e AT AN ANGLE OF 30° WITH VERTICAL.
  - THIS STRUCTURE DRAWING IS BASED ON ARCH.DRG SENT BY MAIL ON DATE :- 14-09-2023.

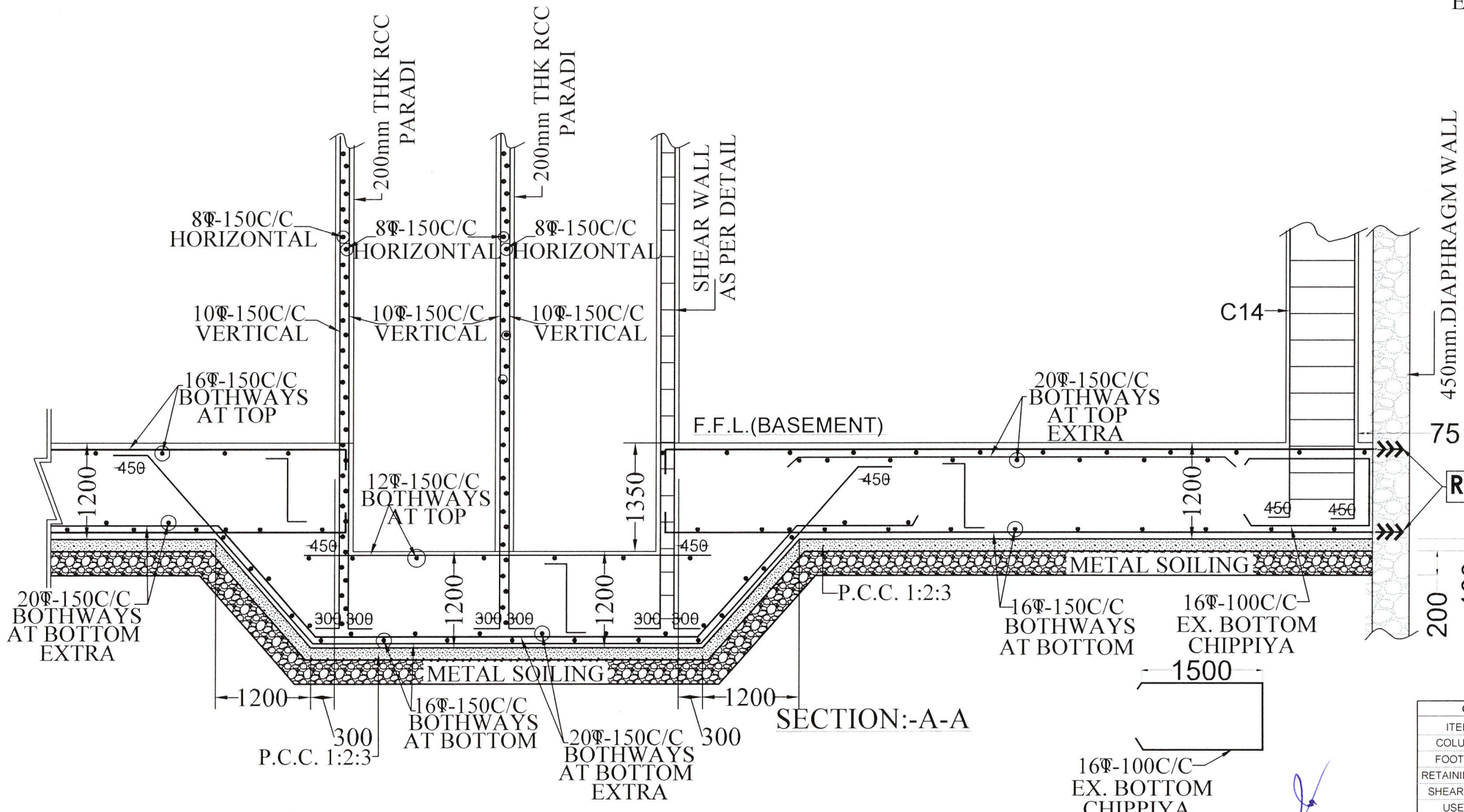

450mm.DIAPHRAGM WALL AS PER DETAIL

REBAR

75

200

100

1500

16Φ-100C/C EX. BOTTOM CHIPPIYA

For ZARNA ASSOCIATES  
Structural Consultants  
Dr. V. R. PATEL  
Ph.D. (Str. Engg.) M.E. (Str.) B.E.(Civil)

CONCRETE GRADE	
ITEM	GRADE
COLUMN	M: 35
FOOTING	M: 35
RETAINING WALL	M: 35
SHEAR WALL	M: 35
USE STEEL GRADE Fe 500D	

DETAIL OF COLUMN FOOTING SECTION

- TAKE FOLLOWING PRECAUTION BEFORE STARTING EXCAVATION OF ECCENTRIC FOOTING/ADJOINING TO OTHER PROPERTY.
- PROVIDE VERTICAL SHEET PILE & SHORING.
  - PROP UP (SUPPORT) THE BOTH SIDE BUILDING VERTICALLY AND HORIZONTALLY.
  - EXCAVATE ONE FOOTING. CAST & FILL UP IT FIRST. THEN EXCAVATE. ANOTHER FOOTING & FILL IT. THUS EXCAVATE & CAST FOOTING ONE BY ONE. (STAGGERED MANNER ON BOTH SIDE)
  - STRUCTURAL ENGINEER IS NOT RESPONSIBLE IF ANY ACCIDENT OCCURS TO THE ADJOINING PROPERTY ON SITE DUE TO CONSTRUCTION PROBLEM.
  - TAKE ALL PRECAUTION DURING CONSTRUCTION OF BASEMENT SO THAT SIDE BUILDING FOUNDATION SHOULD NOT GET DAMAGED/OPENED.
  - DO NOT EXCAVATE ENTIRE BASEMENT AT A TIME. EXCAVATE ONLY 8'-0" & CAST RETAINING WALL STAGE BY STAGE. IN 8'-0" LENGTH WISE.

PROJECT NAME:-		
SBI CORPORATE OFFICE		
ARCHITECT:		
MAMTA SHAH		
STRUCTURAL CONSULTANT :		
ZARNA ASSOCIATES		
STRUCTURAL CONSULTING ENGINEER		
910-915, Samanvay Silver Apartment, Mujmahuda Crossing, Besides Royal Orchid Hotel, Akota Road, Vadodara 390020.		
Tele. ph. /mo. no. :- +91 92276-27339/40		
+9183474-13334 to 39.		
E - Mail :- zarnaasso@yahoo.com		
APPROVED BY:	VRP	
CHECKED BY:	RISHVA	
DRAWN BY:	ISHAQ KHAN	
DATE:	07-10-2023	
PROJECT NO. :	401/17	
DRAWING TITLE:		
DETAIL OF COLUMN FOOTING SECTION		
DRG N0 : 06		
SCALE: N.T.S.	SHEET: A3	N