



NOTE-

1. NO CEILING/ FALSE CEILING SHALL BE PROVIDED IN TOILETS, PANTRY, SAFE ROOM, UPS ROOM, RECORD ROOM, CURRENCY CHEST & STATIONERY ROOM
2. CEILING/ FALSE CEILING SHALL BE PROVIDED IN BANKING HALL OR PUBLIC AREA ONLY.
3. MINERAL FIBRE CEILING- ARMSTRONG / DAIKEN, SHOULD BE PROVIDED WHERE EVER SPECIFIED.
4. ----- PARTITION / FURNITURE LAYOUT BELOW
5. ROUND LIGHT- 2X18 
6. SQUARE LIGHT -600MM X 600MM 
7. AIRCONDITIONED (C.U.) 
8. GRID TILE ARMSTRONG 600MM X600MM X16 MM

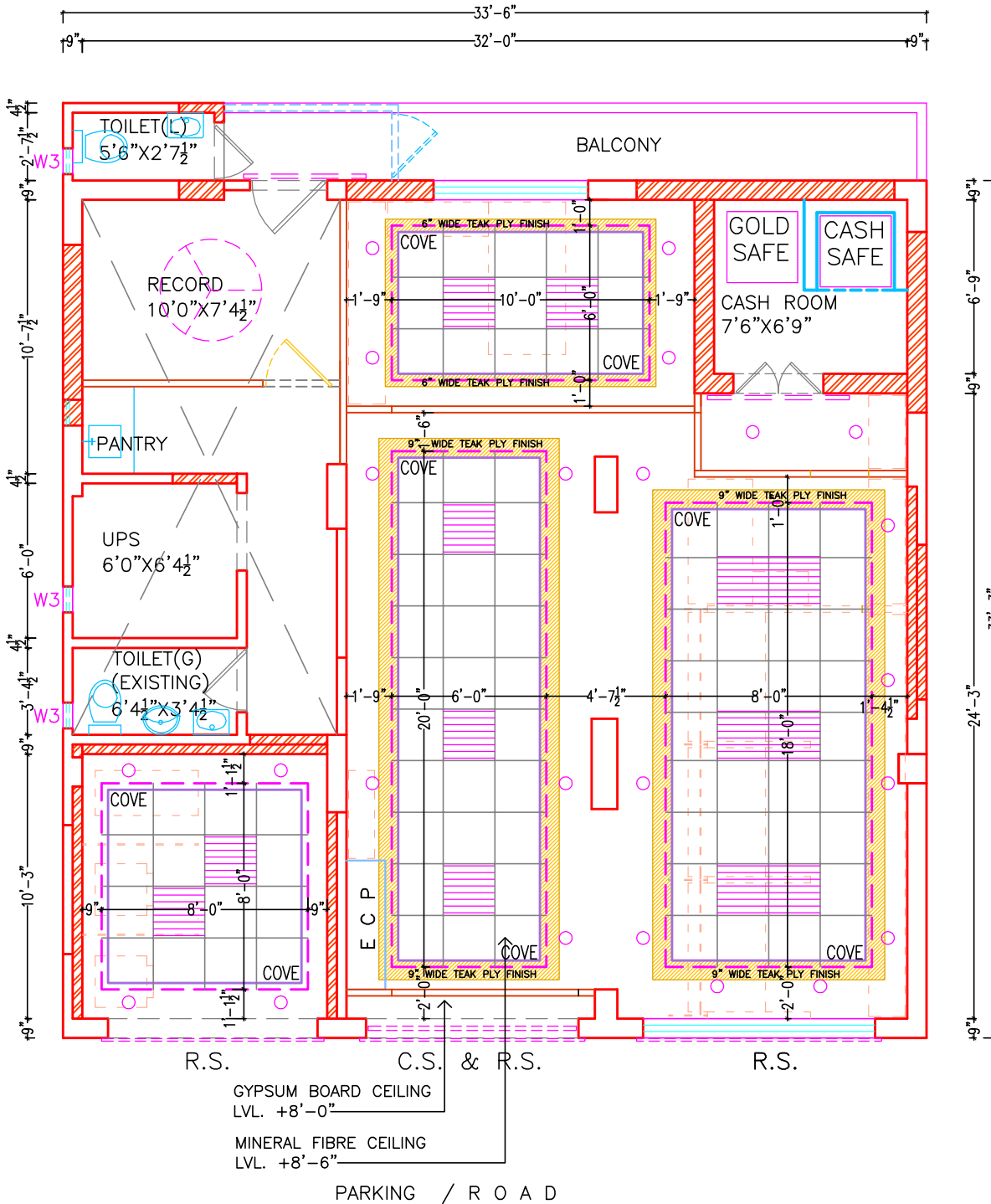

LAYOUT PLAN - G.F.

REV.	DESCRIPTION	DATE
	TITLE REFLECTED CEILING PLAN	
	SCALE	NTS
	DATE	08/12/2023
	JOB NO.	SBI-JA/01
	DRG. NO.	WD-03

**CREATIVE CONCEPTS**  
ARCHITECTS, PLANNERS, INT. DESIGNERS  
BOOTH NO. - 32, SECTOR - 25  
PANCHKULA- 134116.  
PH. 09815788192 (M)