

PROPOSED
 INTERIORS FOR
 STATE BANK OF
 INDIA
 SHIV NAGAR
 UDHAMPUR
 BRANCH
 (J&K)

NOTES:

FLOOR AREA
 =1993.5 SQ.FT.

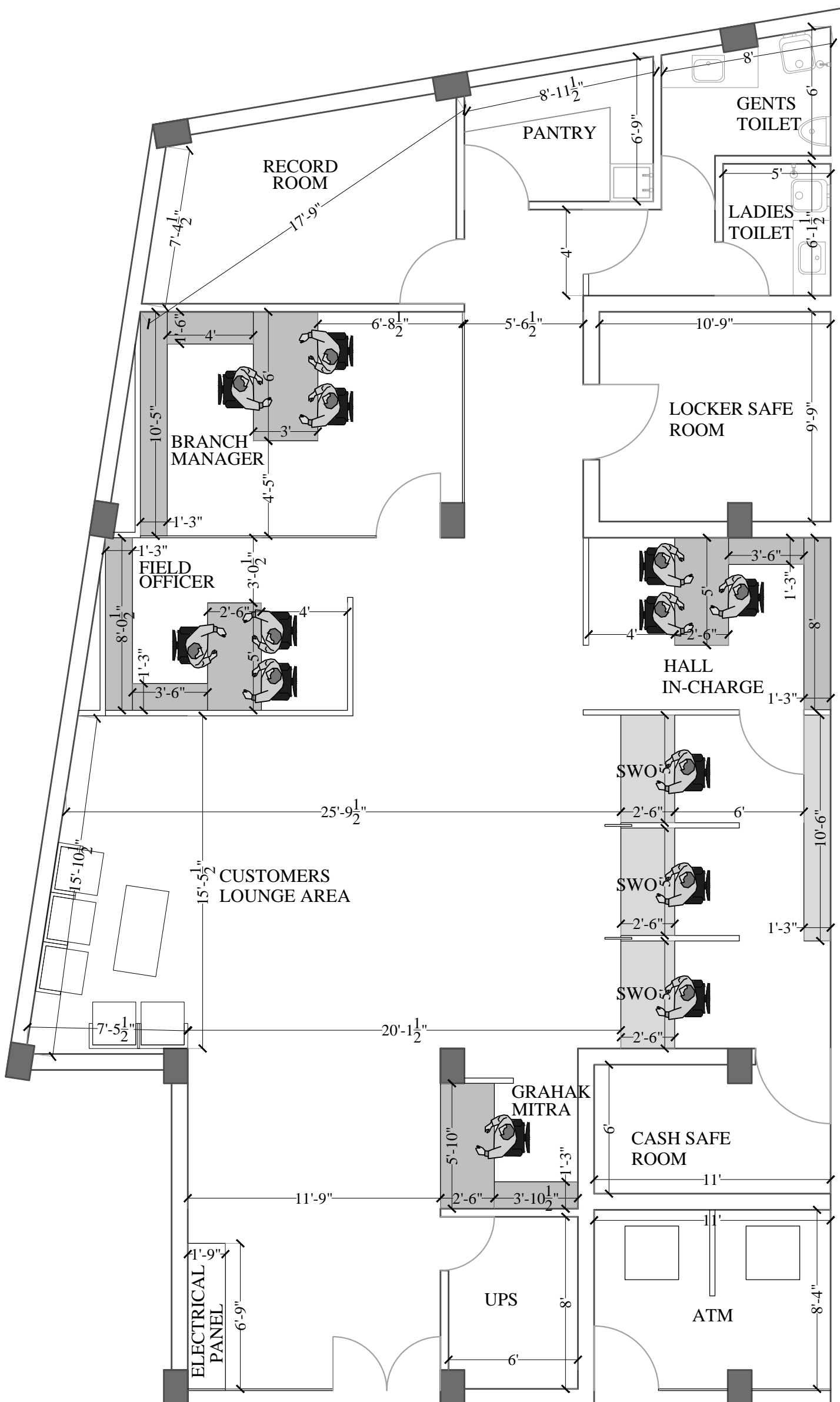

TITLE:
 PROPOSED
 FLOOR
 PLAN

DRG NO. :
 ARCH/SBIL/

DATED:

DRAWN BY:

APPROVED BY:

DESIGNED BY:
 DUTTA AND DUTTA
 ASSOCIATES,
 5035/2, MODERN
 COMPLEX,
 MANIMAJRA,
 CHANDIGARH.
 PH.: 9888321423
 9888443423
 0172-4678035

Akshay Dutta